

Asian Hope Missionary Outreach
of the Philippines

Training Rescued Saved
Optimism Kindness Promise
Vision Love Possibility
Help Compassion Empower

The Rehoboth Children's Home
Expansion Project

Capital Campaign
Learning Hope Future Give
Housing Support
Care Nurture Forever
Promise Redeemed Adoption Sustain Restoration

Forever Sustain *Hope* Future Give
Training Housing Support
Promise Schooling Nurture
Redeemed Care Restoration

Every Child Growing in a Loving, Caring Family

Learning Possibility **Saved**
Kindness Adoption Rescued
Promise Love Compassion
Vision Help Optimism Empower



I will not leave you as orphans. John 14:18



History

The vision of Bob and Barbara Morriss, founders of Asian Hope Missionary Outreach and the Rehoboth Children's Home, was to create a safe haven for destitute children in the Philippines. They worked tirelessly over a period of 10 years to complete the construction of the Children's Home, with the Sacred Portion Children's Outreach coming alongside them in 2000 to help bring that vision to completion. Four humble, but well-equipped modern buildings were completed in 2003. These include two children's houses, an administrative building and a kitchen/laundry with guest quarters for adoptive families. The Rehoboth Children's Home was registered by the Department of Social Welfare and Development and began receiving children in July 2003. The home provides a loving, family oriented atmosphere for children 0 to 8 years old who have been orphaned, abandoned, surrendered, abused or neglected by their birth family. The children thrive at Rehoboth with good nutrition, proper medical care and a stimulating environment with quality interaction from their caregivers.

Wish *Redeemed* **Mercy** *Dream* **Trust**



Rehoboth Children's Home

The houses have the capacity for a total of 24 children. Since its inception, a total of 84 children have come through the doors of the Rehoboth Children's Home. Through intervention, 23 of those children were reunited with their birth families. But sadly, circumstances are such that reunification is not possible in many cases. For these children, the staff at the Rehoboth Children's Home actively work to make an alternative plan for their futures through adoption. Twenty-nine children have found new homes around the world including in the U.S., Canada, Australia, Italy, Spain and Finland. Three children have been placed with adoptive families within the Philippines.

All of the functions and activities of the Rehoboth Children's Home, including fiscal management, are overseen by the Board of Directors of Asian Hope Missionary Outreach of the Philippines, Inc. The board is comprised of four Philippine nationals, one American and one British expatriate, all having been involved since the inception of the ministry and all having a heart for improving the futures of children and families in the Philippines.

Current funding for the operation of the Rehoboth Children's Home comes from donors in the U.S. through the Sacred Portion Children's Outreach, Siloam Christian Ministries in the UK, various donors in Australia, and a Child Sponsorship program managed by the Sacred Portion Children's Outreach.

Love Optimism Care Sustain Future Rescue



A Brighter Future

Every child deserves to have a family to nurture and guide them through their growing-up years. By all rights, it should be the child's birth family that provides this backdrop for love, growth and development. For many children in the Philippines and across the globe, this is not the case. It is estimated that there are as many as 143 million orphans worldwide. Poverty often cripples a family's ability to care for their children and the children end up neglected or abandoned. Death of a parent may leave a child orphaned with no extended family members in a financial position to assume responsibility for the child. Young women become pregnant and do not have a support system or the means to be able to raise a child themselves. Many children are growing up in orphanages in the Philippines, which are no substitute for a family. The vision of the Rehoboth Children's Home Expansion Project is twofold:

- 1) To provide for children who have lost their families due to poverty or other circumstances and to make an alternative plan for their future through adoption.
- 2) To address the needs of Filipino families by providing support systems that will help families stay intact and give them the capability to raise their own children.

Promise
Optimism

Kindness
Sustain

Adoption



Capital Campaign

The Sacred Portion Children's Outreach, along with Asian Hope Missionary Outreach of the Philippines, is working to support, educate and preserve Filipino children and their families by establishing an extraordinary facility to serve Sampaloc, Tanay, the Philippines. The purpose of the Capital Campaign is to raise the funds for the construction of this facility with the end result being a brighter future for the children of the Philippines.

- Imagine the change you can create if a family doesn't have to give up its children because the parents cannot care for them.
- Imagine the hope you can give if a widow or young, unwed mother can gain the skills to support herself and her children.
- Imagine a place where expectant mothers' medical needs are met and healthy babies become healthy children, families and communities.

Compassion Redeemed **Mercy**
Help Empower



Expanding the Vision

It is crucial that we continue to address the immediate concern of children needing to be rescued from dire circumstances. However, it is imperative that we also look at what causes families in Philippine culture to break down and what support can be offered to keep them intact. The Sacred Portion Children's Outreach and Asian Hope Missionary Outreach are looking to the future with an expanded vision for the Rehoboth Children's Home that will do far more to positively impact the community's health, education and economic needs, and thus prevent children from becoming abandoned or orphaned. In March 2007, the final payment was made on 5 acres of land located directly across the road from the Rehoboth Children's Home. Highlights of the proposed expansion of Rehoboth include a new baby home, medical clinic, school, vocational training center, employment opportunities and sustainable agriculture. These pieces will allow the infrastructure to be built to attend to the immediate physical and emotional care of children and families and, more significantly, to address the future economic and cultural viability of Sampaloc. The blueprints are already in place thanks to the support and dedication of Engineering Ministries International (eMi), who recognized that assistance on this project was needed due to a lack of qualified professionals in this relatively isolated community. eMi spent 10 days at the expansion site learning about Sampaloc's history, local materials and building methods, and the area's weather patterns in order to generate design plans that will be well received and stand the test of time.

Vision *Schooling* Housing
Emotion

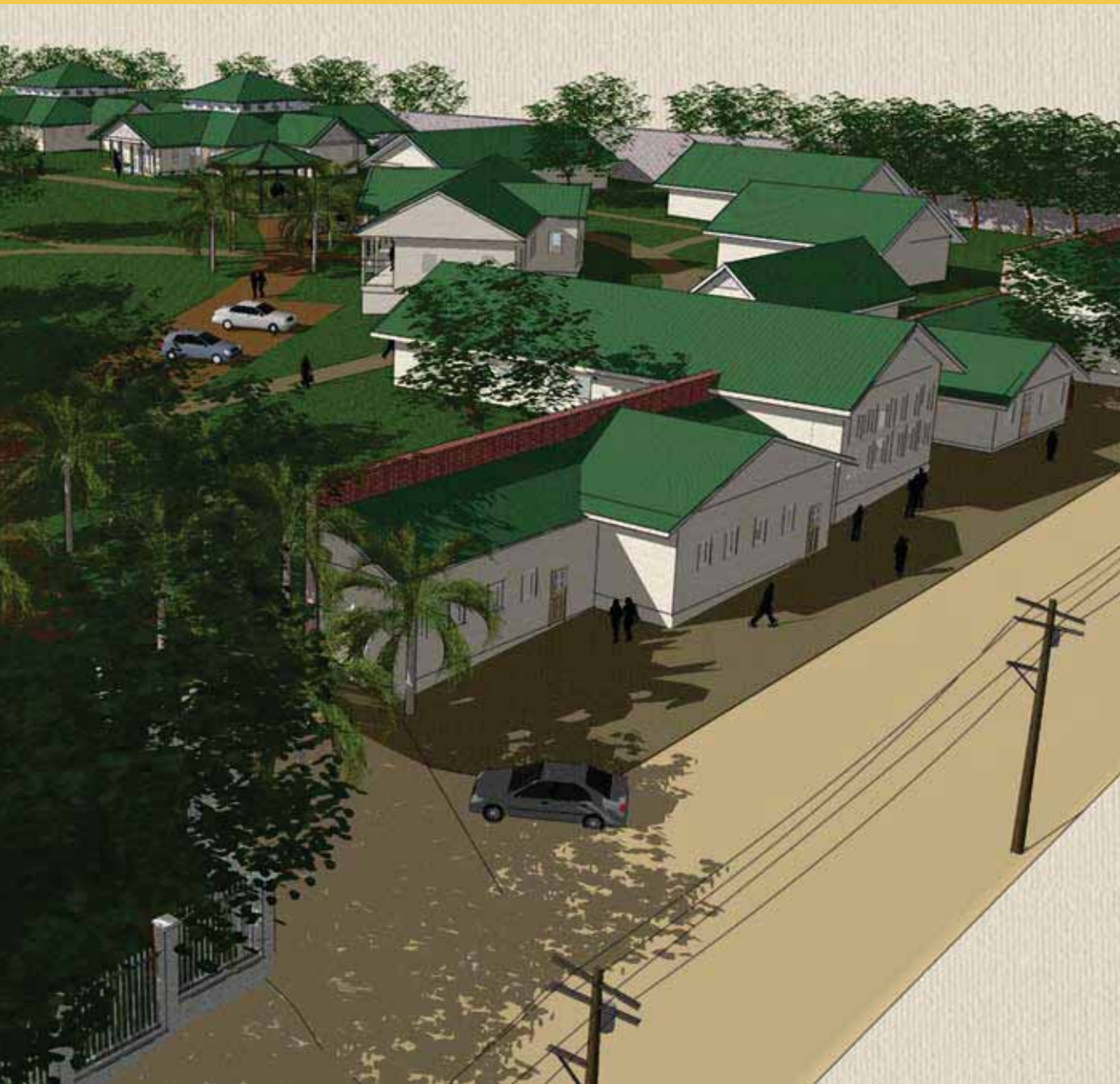

Master Plan

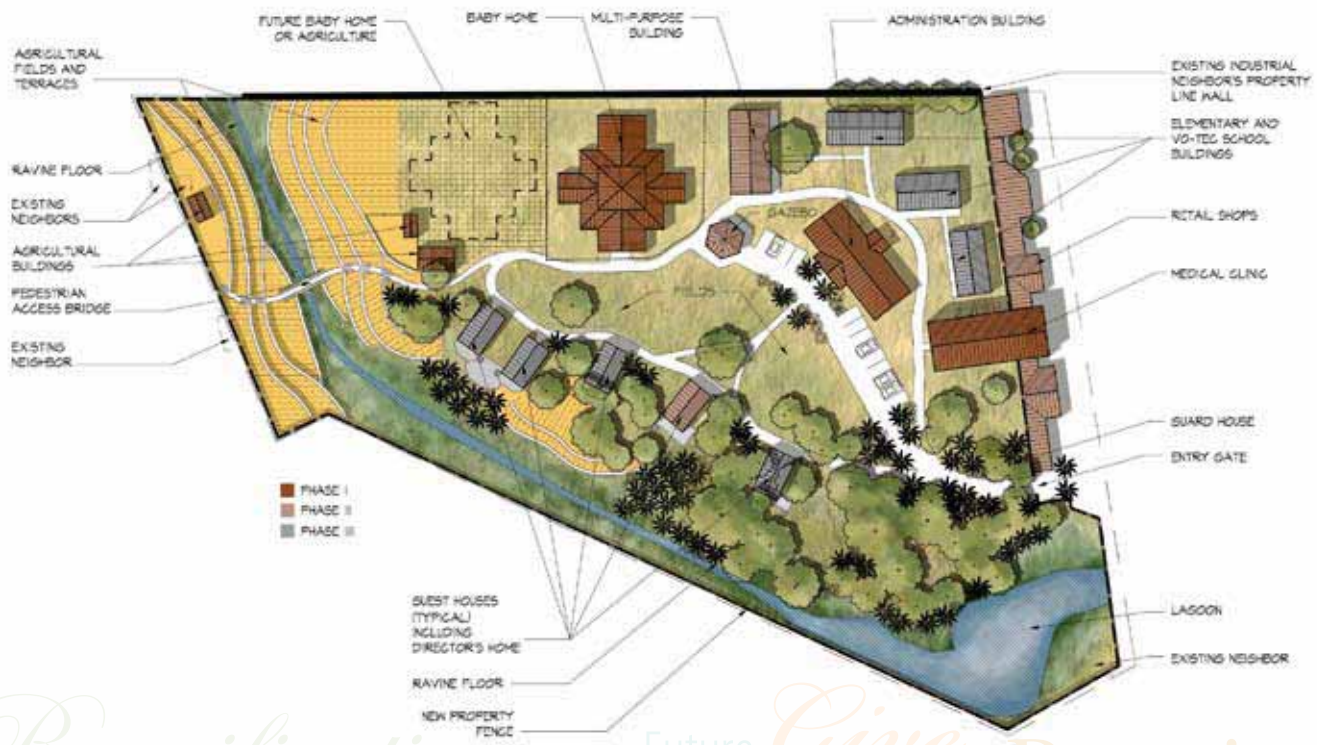

Reunification Future Give Promise



Phase 1

- Security Wall
- Bonnie's Heart Baby Home
- Medical Clinic
- Administration Building
- Sustainable Agriculture

Wall	\$129,375
Baby Home	103,125
Admin Bldg.	55,600
Clinic.....	68,700
Agriculture	75,000
Site Work.....	75,000
TOTAL	\$506,800

Phase 2

- Commercial Strip
- Multipurpose Hall
- Outdoor Pavilion
- Staff Housing

Multipurpose Bldg. ..	\$ 50,000
Gazebo	10,600
Retail Shops	121,800
3 Bedroom Bungalow ..	33,000
Site Work.....	41,000
Total	\$256,400

Phase 3

- Preschool
- Elementary School
- Vocational Training Center
- Additional Housing for
Work Teams and Volunteers

Preschool	\$ 32,000
Vo-Tech.....	68,400
Elementary.....	29,000
2 Bedroom Bungalow ..	23,000
(3) 1 Bedroom Bungalows.	48,400
Site Work.....	36,000
Total	\$236,800

Grand Total \$1,000,000

Kindness
 Employment Love Possibility Parenting



An Opportunity to Change Lives

On July 14, 2005, a very malnourished 10-month-old baby was admitted to the Rehoboth Children's Home. Initially, the staff was very worried about the condition of this baby because he was not showing any emotion and could not even hold his head up by himself. With the help of a nutritionist who consulted with the Rehoboth staff, John Carlo (JC) steadily gained weight to where, four months later, he did not even look like the same child. Today, JC is a healthy 3-year-old boy. In some cases, such as that of JC, admitting a child to the Rehoboth Children's Home can be a saving gift of life.

The need may always exist for a safe haven in which children can recover from a devastating start in life and move on to a brighter future. But we need to set our sights on what we can do to provide families in the Philippines with the support they need to rise above their circumstances so that children like JC do not end up on death's door. Education, employment and access to affordable medical care are three key elements that are incorporated into the expanded vision of the Rehoboth Children's Home.

Hope Care *Future Give*
Sustain Nurture Support



A Gift of Hope

You can help children like JC who are victims of poverty to have a second chance at life and a future with an adoptive family. Ultimately, you can help ensure fewer children end up in orphanages. The Sacred Portion Children's Outreach and Asian Hope Missionary Outreach have a 3-year capital campaign underway to raise \$1 million. This campaign will fund the three phases of development.

With the creation of the Rehoboth Children's Home master plan on the newly acquired 5 acres of land, we invite you to become a part of this exciting new project by giving generously to our capital campaign. We ask for your support. Your generosity will help change people's lives in a real way, a way that meets them exactly as they are, with compassion and the hope that is Jesus. Gifting opportunities and a gift agreement form are enclosed with this brochure.

Employment **Housing** Ministry *Training*



Phase 1

Bonnie's Heart Baby Home

As children leave for adoption, their places are quickly filled. Rehoboth has a strong reputation with local welfare agencies and the Department of Social Welfare and Development, from which it receives referrals of children needing placement. But, if the home is full, these children must either be turned away or the home operates above capacity for a time. The latter is most often the case, as it is very difficult to not admit a child who needs to be rescued from a dire situation. Bonnie's Heart Baby Home, named in memory of Bonnie Burgard of Bozeman, Montana, will accommodate an additional 24 children over the present facility. The baby home will be more appropriately designed for babies and toddlers with adequate diapering/bathing facilities and a larger nursery.

Once the baby home is built, the current two houses will be used exclusively for the older children, preschool age and up. We have seen the need that exists and anticipate that all of the children's buildings will operate at capacity with increased referral activity from the local social welfare agencies.

Learning *Rescued* Future Nurture *Forever* Parenting



Medical Clinic

Medical services in the area of Sampaloc are substandard and it is a three-hour drive one way through heavy traffic to reach the metropolitan area of Manila. This is not even an affordable option for most people living in this rural community. Not only do children suffer from a lack of adequate medical care, but adults often die from treatable diseases, leaving their children as orphans. A typical scenario in the Philippines is the death of a spouse resulting in the surviving parent being unable to cope with the burden of raising the children, and thus surrendering them to an institution.

Because the Rehoboth Children's Home takes in children who have been sick, malnourished and neglected, medical care is an important part of our program and budget. A medical clinic will serve the children in residence at the Rehoboth Children's Home and will also provide the community of Sampaloc with affordable, accessible, quality medical care. The clinic will have access from both the street front and from inside the compound.

Development Support *Restoration* Human



Zoe Lying-In Clinic

The Zoe Lying-In Clinic is located on the current premises of the Rehoboth Children's Home, providing prenatal care and delivery assistance to low-income mothers who are unable to avail themselves of proper medical care. The clinic was established by Bob and Barbara Morriss, the founders of Rehoboth, with the aim of preventing mother and infant mortality in childbirth.

The vision for the Clinic grew out of a tragic event in which the wife of a Rehoboth employee lost her baby in childbirth because the couple did not have access to, nor could they afford, medical services.

The services of the Zoe Lying-In Clinic will be moved to the new medical clinic, which will have more adequate lying-in and birthing facilities. The Zoe Lying-In Clinic will have regularly employed medical personnel and medical teams from overseas will also be invited to serve on short-term missions.

Adoption Promise Optimism
Family Belief Vision



Sustainable Agriculture

We would like to see the Rehoboth Children's Home develop some self-sufficiency, particularly in light of an increased food budget as the home expands to serve more children. The new land has 50 to 80 mango trees and other fruit trees and has the potential for some self-sustaining operations. We envision gardens where the home can grow some of its own produce. Raising a few hogs and chickens will be another possibility. Our current gardener has attended trainings in sustainable agriculture and is poised to take off on this part of the project. Growing fruit and vegetables and raising animals will be a wonderful hands-on learning opportunity for the children.

Administration Building

The Rehoboth Expansion Project encompasses a variety of services that will be contained within a secure compound. At the heart of the compound will be the administration building, which will house administrative support services for the multifaceted functions of the entire compound. The administration building will be spacious enough to include a social work division or wing, counseling rooms, general administration, an area for board of director functions and record storage. Once the administrative functions are moved to this new building, the administration building on the current premises will be converted to additional housing for 10 to 12 older children.



Phase 2

Multipurpose Building

The Rehoboth Children's Home's goal is to become a model center providing quality care for children and implementing best social work practices in case management. Phase 2 includes the construction of a multipurpose building in which trainings can be held for staff from other child caring agencies in the Philippines. Through such trainings, standards will be raised throughout the Philippines to ensure that children residing in orphanages receive the best possible care and that their cases are quickly moved to either reunification or adoption.

Parenting classes, counseling and coaching of parents are also part of the plan for the training center, as a means of strengthening marriages and families and giving them the skills to parent well.

An outdoor pavilion acts as an extension of the multipurpose building, providing a place for outdoor functions, programs and parties.

Vision *Kindness* Possibility
Love *Compassion*



Commercial Strip

The commercial strip along the street front will allow for the development of small businesses. Whether these businesses are actually operated by Asian Hope Missionary Outreach or the space is leased out to independent proprietors, the commercial strip will provide a source of income for the Rehoboth Children's Home.

Many families living in the area of Sampaloc are without employment. Poverty is one of the chief contributing factors to children being abandoned or neglected by their birth families. The commercial strip will provide employment opportunities for people in the community of Sampaloc, thereby giving families who are struggling financially a means of living to support their children.

Asian Hope Missionary Outreach of the Philippines will manage the commercial strip and select businesses for development that fill a gap in the community. For instance, there is no place within 30 miles to purchase medicines. A pharmacy located in the commercial strip would save people the time and expense of taking a "jeepney" down the road to Tanay. An Internet café is another service that currently does not exist in the community. Other possible business ventures include a drop-off laundry for soldiers living on the local military base and a Christian bookstore/library.



Housing

One of the core values of Asian Hope Missionary Outreach and the Sacred Portion Children's Outreach is an invitation to others to be involved and join in the ministry. This includes missionary couples who would do an extended stay to help with the running of the Rehoboth Children's Home and its expanded services, work teams who come on short-term missions to help with construction and repairs, and health care professionals such as dental teams who would come to serve the children and the community in the medical clinic. Because of the isolated location of the project, lodging is not readily available and, therefore, missionaries and work teams need to be accommodated on site. Phases 2 and 3 include the construction of housing for staff, work teams and volunteers. The housing consists of a variety of modest one, two and three bedroom bungalows tucked in the trees on the property, with food service located in the multipurpose building.

A secondary use of the bungalows would be to shelter women and children in crisis. Rather than building a separate facility to temporarily house women and children who are in an abusive situation, the bungalows can be used for this purpose. Women who are in crisis are prone to making hasty decisions to surrender their children to a child caring facility such as Rehoboth. By being temporarily housed and plugged in to counseling services in the social work unit, these women can be given time to explore their options with the guidance of a trained social worker.



Phase 3

Schooling

It is a high priority that the children residing at the Rehoboth Children's Home are provided with opportunities for learning to foster normal development. This starts as early as infancy, knowing the importance of stimulation during this critical period of brain development.

The Rehoboth Early Learning Center is located on the current premises of the Rehoboth Children's Home, serving the children in residence and a limited number of needy children from the community. The preschool program will be relocated to the new site during Phase 3 of the project and will be expanded from its current capacity of 12 children to several classrooms with 10 to 12 children in each.

The age population of the Rehoboth Children's Home has been mainly infants and toddlers. As the home grows, however, we anticipate that it will include an older population of children who will need formal education at the elementary level. Phase 3 also includes the construction of an elementary school that will, once again, serve both the children in residence and in the community.



Vocational Training Center

In an effort to address the educational needs of adults, we plan to develop an education foundation and a vocational training center. Financial assistance for the pursuit of educational goals will help adults who would not otherwise have this opportunity to develop a career path. Likewise, vocational training will help unemployed people develop marketable skills such as sewing, auto mechanics or computer competencies so they may become productive members of the community and providers for their families.

The commercial strip developed in Phase 2 of the project will be a good tie-in to the vocational training center, providing opportunities for on-the-job training and employment.

Emotion *Schooling* Learning
Possibility *Sustain*



I brought you forth on the day you were born. Psalm 71:6



Rehoboth, God has made a place for us! Genesis 26:22



My plan for your future has always been filled with hope. Jeremiah 29:11

©2009 All rights reserved. Printed in USA. All design services donated by Hart Associates.



To you, it's just a signature ...

We feel privileged to have your generous consideration in giving a gift to the Rehoboth Children's Home Capital Campaign. Only you and the Lord know what kind of gift you are capable of and comfortable giving. We realize you receive many requests for help, and we do hope our request has taken a special place in your heart. We can't think of a more needy audience. Please know that your generous gift will work directly to benefit some very needy children and, in many cases, their parents. We are hopeful and prayerful that you will consider a major gift to our campaign and please be aware that you can pledge this amount over three years. We have included this gift agreement with all the pledge information needed. Thank you so much for your prayerful consideration.

Donor Information

Name _____ Phone (_____) _____

Address _____ City _____ State _____ Zip _____

E-Mail Address _____

NOTE: Gifts to the Rehoboth Children's Home Capital Campaign are deductible to the full extent of federal and state tax laws. Official receipt will be forthcoming from the ministry office. A reminder will be sent in advance of due date(s). Please make checks payable to Sacred Portion Children's Outreach.

To a child, it's hope.

Gift Information

I wish to support the Rehoboth Children's Home Capital Campaign with a total gift of \$ _____

My total gift is enclosed

I intend to pledge my gift over:

1 year

2 years

3 years (The ministry office will invoice accordingly.)

Recognition

My/our gift may appear in donor listings

Please list your name as you would like it to appear in all donor listings and publications

This gift is in memory/honor of _____

My/our gift is anonymous. Please don't publish our name.

Matching Gift Information

I/we work for a corporate matching gift employer. Please contact me or

_____ to take fullest advantage of my company's program.

Signature of Donor/Date _____

Signature of Donor/Date _____